

ICPS-1280-K

8 埠 10/100TX + 2 埠 10/100/1000 SFP + 8 PoE 供電 複合埠
8 埠 PoE 供電型工業乙太網路交換機

- 符合 IEEE 802.3at+ PoE 電力線供電標準，單埠輸出高達 30W
- 雙電源輸入並支援極性保護與過電流保護
- 符合工業安全規範標準
- 支援 Non-Blocking 無阻塞設計
- 支援存儲轉發設計
- 具備告警輸出功能，可連接外部警示燈
- 耐高溫設計，操作溫度範圍 -20°C ~ 60°C
- 超寬電壓輸入設計 12VDC ~ 48VDC
- 符合 IP-30 強度保護
- 寬電壓輸入設計 48VDC~54VDC
- 適用環境：安防領域、戶外監控、工業自動化、工業視覺檢測、太陽能發電應用



OVERVIEW

萬東科技 ICPS-1280-K 提供 8 埠 10/100M 高速乙太網路端口，包含 2 port 10/100/1000M RJ-45 端口複合 2 port 1000M 光纖埠，並支援 SFP 標準界面，其中 1~8 埠支持 POE (power over Ethernet) 符合 IEEE802.3 at /IEEE 802.3 at+，最高輸出每埠 30W，可應用於多數 PTZ IP-cam 及 Speed Dome 需求。

ICPS-1280-K 支援雙電源輸入，以及(power failure alert)電源遺失自動告警顯示，該功能並支援外部警示燈號，以提高設備安全性。同時支援滑軌式(Din-Rail) 或壁掛式安裝，方便於安裝施工。

ICPS-1280-K 是為符合嚴峻使用環境而設計，全機身符合 IP-30 強化保護，並通過相關工業安全規範檢驗，EMI 檢磁規範及德凱宜特實驗室通過各式嚴格試驗包含落下，震動及衝擊試驗，以確保產品設計的可靠性及穩定度。

ICPS-1280-K 採 Non-Blocking 無阻塞設計，確保在各種狀況下能全速傳輸，同時每埠最高可提供 200Mbps 雙向傳輸速率，提供足夠的帶寬處理能力，確保網路可長時間並且穩定使用，是提升網路性能的最佳方案。

ICPS-1280-K 可與戶外無線接入點(WIFI-AP)及 Speed Dome/IP-CAM 等設備連接，並可應用於安防科技、戶外監控、工業自動化、工業視覺檢測、太陽能發電應用等環境。

ICPS-1280-K 支援寬溫設計，符合-40~75 度操作溫度，可長時間安裝於戶外機箱，是最佳工業級網路交換機方案。

FEATURES & BENEFITS

- 系統介面 / 效能
 - RJ-45 埠支援 Auto MDI/MDI-X 功能
 - 嵌入式 8 埠 PoE 供電模組
 - 存儲轉發系統架構
 - 背板頻寬 (Switching Fabric): 1.0Gbps
 - 16K MAC 網路地址表
- 寬溫設計(-40°C~75°C)
- 強化設計，符合 IP-30 保護
- 寬電壓輸入直流 DC 12-48 V，雙電源設計
- 符合工業用檢磁及安全規範
- 支援極性保護，過電流保護

DIMENSIONS

Datasheet Version 1.6

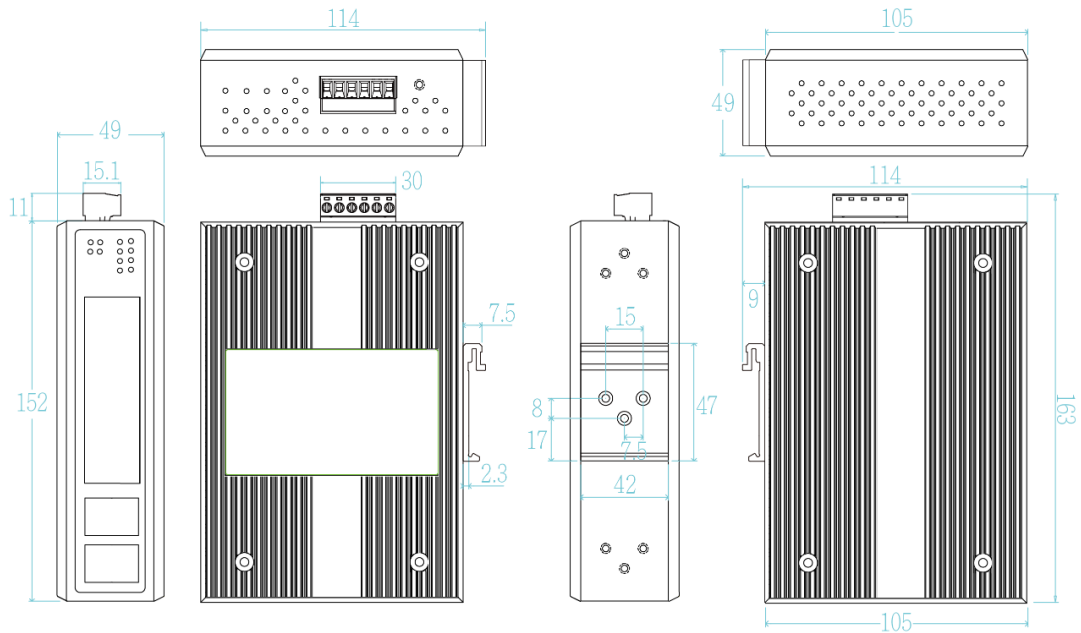
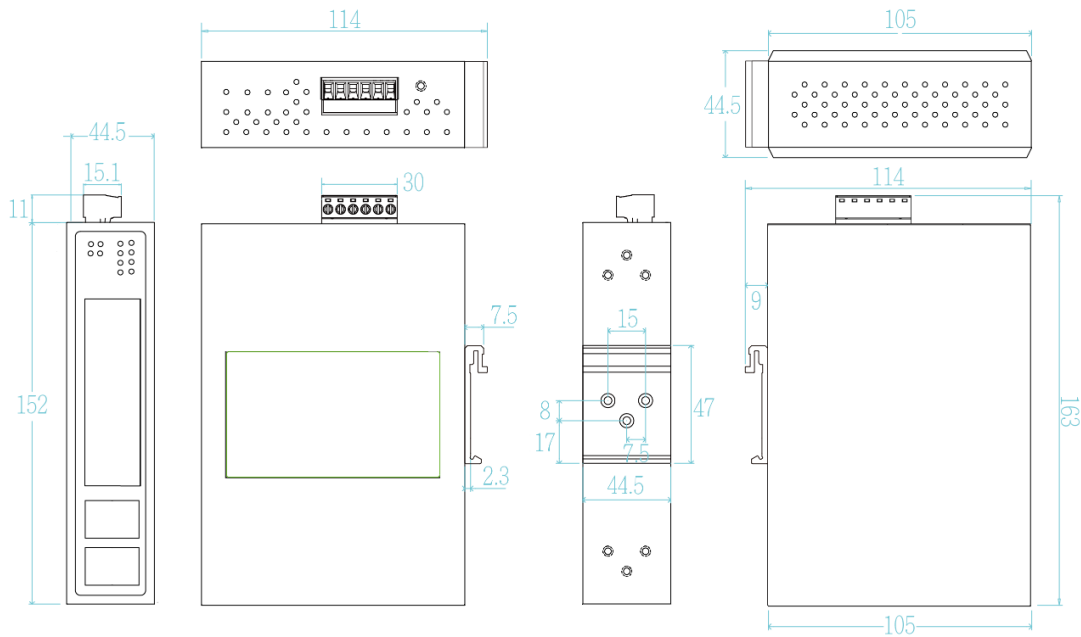
ICPS-1280-BE

ICPS-1280-K

SPECIFICATION

IEEE Standards	IEEE802.3 10Base-T Ethernet IEEE802.3u 100Base-TX IEEE802.3ab 1000Base-TX IEEE802.3z Gigabit Fiber IEEE802.3x Flow Control and Back Pressure IEEE 802.3af PoE specification IEEE 802.3At+ PoE specification	Connectors	148,810pps for Gigabit Ethernet port 10/100TX: 8 x RJ-45 with auto MDI/MDI-X function Support 8 PoE injector function 100M/1000M fiber: 2 x dual speed SFP slot for Single-mode or Multi-mode type fiber cable
Switch Properties	Back-plane (Switching Fabric): 5.6Gbps Packet throughput ability (Full-Duplex): 1488100pps @64bytes	MAC Address	16K MAC addresses
Transfer Rate	14,881pps for Ethernet port 148,810pps for Fast Ethernet port	Packet Buffer	4M bits
		Processing	Store-and-Forward
		Network Cable	10Base-T: 2-pair UTP/STP Cat. 3, 4, 5, 6 cable EIA/TIA-568 100-ohm (100m) 100Base-TX: 2-pair UTP/STP Cat. 5, 6 cable EIA/TIA-568 100-ohm (100m)

Optical Cable	Multi-mode: 50/125um~62.5/125um	用-K ,-E 系列) Total power 128Watts @ 24VDC input (適用-B 系列)
	Single-mode: 9/125um	
PoE pin Assignment	Available distance: 2km (Multi-mode)/30km (Single-mode)	Consumption 5.76 Watts (Full load: Only Ethernet)
	Wavelength: 1310nm (Multi-mode/Single-mode)	Overload Current Present
Protocol	RJ-45 port #1 - #8 support IEEE 802.3at End-point; Alternative A mode.	Reserve Polarity Present
	Positive (VCC+): RJ-45 pin 1,2 Negative (VCC-) : RJ-45 pin 3,6 Data (1,2,3,6)	Operating Humidity 5% to 95% Non-condensing
Case Dimension	CSMA/CD	Operating Temperature -40°C~75°C / -40°F~167°F
	Aluminum case,IP-30;	Storage Temperature -40°C~85°C / -40°F~185°F
Weight	49mm(W)x105mm(D)x152mm(H)	MTBF Over 190000 hours ,(>20 Years)
LED	648g	FCC(EMI) FCC Part15,SubpartB ,Class A
	Power Indicator Green LED x 2 10/100Base-T(X) RJ45 port indicator Green for port Link/Act. Amber for Duplex/Collision	CE(EMi) EN61000-6-4(EMI)
Power Supply	48~54VDC, Redundant power with polarity reverse protect function and removable terminal block	CE(EMS) EN61000-4-2 (ESD), EN61000-4-3 (RS), EN61000-4-4 (EFT), EN61000-4-5 (Surge), EN61000-4-6 (CS), EN61000-4-8, EN61000-4-11 EN61000-6-2(EMS)
	POE power per port 30watts @54V Total power 200Watts @ 48VDC input (適用-K ,-E 系列) Maximum total power 240Watts @ 54VDC input (適	Stability Testing IEC60068-2-31 (Drop Off) IEC60068-2-27 (Shock) IEC60068-2-6 (Vibration)
Warranty	3 years	*Future Release **Optional

ORDERING INFORMATION

- **ICPS-1280-K**
8 10/100TX +2 10/100/1000TX/Giga SFP w/8 PoE Injector Industrial Switch; Input Power 48VDC ~ 54 VDC ; Include of 120W industrial power ; -20°C~60°C;
- **ICPS-1280-E**
8 10/100TX +2 10/100/1000TX/Giga SFP w/8 PoE Injector Industrial Switch; Input Power 48VDC ~ 54 VDC ; -40°C~75°C;
- **ICPS-1280-BE**
8 10/100TX +2 10/100/1000TX/Giga SFP w/8 PoE Injector Industrial Switch; Input Power 24VDC ~ 36 VDC ; -40°C~75°C;

OPTIONAL ACCESSORIES

Mini GBIC (SFP)

- | | |
|--|--|
| ■ 8330-162 MINI GBIC 1000SX (LC/0.5km) Transceiver | ■ 8330-188 LTSFP-1000BX-10KM Transceiver (WDM 1310) |
| ■ 8330-163 MINI GBIC 1000SX2 (LC/2km) Transceiver | ■ 8330-189 LTSFP-1000BX-10KM Transceiver (WDM 1550) |
| ■ 8330-165 MINI GBIC 1000LX (LC/10km) Transceiver | ■ 8330-186 LTSFP-1000BX-20KM Transceiver (WDM 1310) |
| ■ 8340-0591 MINI GBIC 1000LHX (LC/40km) Transceiver | ■ 8330-187 LTSFP-1000BX-20KM Transceiver (WDM 1550) |
| ■ 8330-166 MINI GBIC 1000XD (LC/50km) Transceiver | ■ 8330-180 LTSFP-1000BX-40KM Transceiver (WDM 1310) |
| ■ 8330-169 MINI GBIC 1000XD (LC/60km) Transceiver | ■ 8330-182 LTSFP-1000BX-40KM Transceiver (WDM 1550) |
| ■ 8330-167 MINI GBIC 1000ZX (LC/80km) Transceiver | ■ 8330-181 LTSFP-1000BX-60KM Transceiver (WDM 1310) |
| ■ 8330-170 MINI GBIC 1000EZ (120km) Transceiver | ■ 8330-183 LTSFP-1000BX-60KM Transceiver (WDM 1550) |
| ■ 8330-168 MINI GBIC 1000T (100m) Transceiver | ■ 8330-184 LTSFP-1000BX-80KM Transceiver (WDM 1490) |
| ■ 8330-061 100Base LX 30KM, Single-mode, LC Transceiver | ■ 8330-185 LTSFP-1000BX-80KM Transceiver (WDM 1550) |
| ■ 8330-060 100Base FX 2KM, Multi-mode, LC Transceiver | |

WanDong Technology Co.,Ltd..
www.wandong.com.tw
shsh0963@gmail.com

© 2021 Copyright WanDong Technology Co.,Ltd. all rights reserved.
 The revise authority rights of product specifications belong to WanDong Technology Co.,Ltd..
 WanDong may make changes to specification and product descriptions at anytime, without notice.